

## Materials

- 8½" x 11" paper, at least 3 sheets
- colored markers, pencils
- scissors
- glue

# Make a Pop-Up Card!

How do you make a card so the inside pops up when you open it? Try this!

## Directions

- 1** Fold a piece of paper in half. Starting from the folded edge, make 2 parallel cuts as shown. The cuts should be the same length, and less than 1 inch apart.

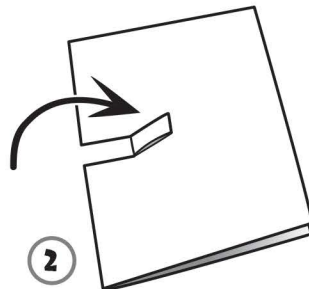
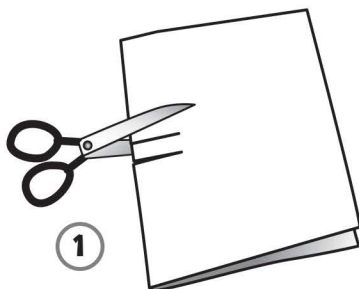

- 2** Fold the flap back and crease it.

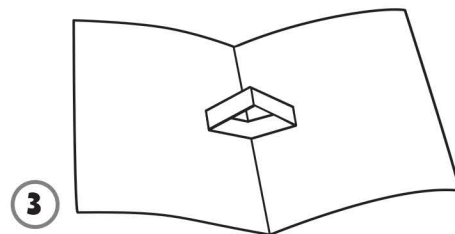

- 3** Put the flap back where it was. Open the card and push the flap through to the inside. Pinch the crease on the flap. This is a pop-up platform.

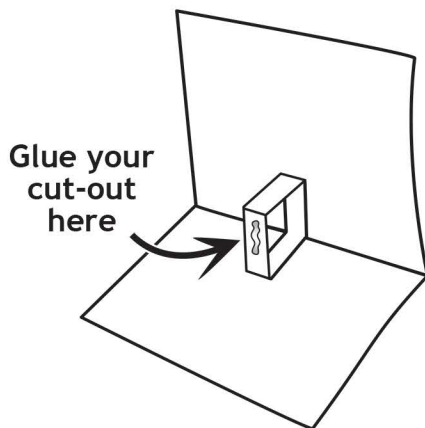

- 4** Cut out something you want to pop up. (Ideas: a tree, a house, a flower, a butterfly...) Glue it to the platform. Open and close your model. Do you see how it works?
- 5** Now use your model to experiment. How many pop-up flaps will you want for your card? What happens if you make some platforms with long cuts, and others with short cuts?

**Watch CYBERCHASE on PBS KIDS!**  
**Check local listings or visit [pbskids.org/cyberchase](http://pbskids.org/cyberchase).**